

**NOTES:**  
 ALL DIMENSIONS TO BE CHECKED ONSITE.  
 ANY DIMENSIONAL DISCREPANCIES FOUND  
 ONSITE MUST BE REPORTED TO  
 DESIGNER / PROJECT MANAGER.  
 DRAWING TO BE READ IN CONJUNCTION WITH  
 ANY SPECIFICATIONS, SCHEDULES,  
 CONSULTANTS DRAWINGS AND DETAILS.  
 FULL SITE SURVEYS RECOMMENDED BEFORE  
 COMMENCEMENT OF ANY SITE WORKS.  
 LAYOUTS ARE SUBJECT TO BUILDING  
 CONTROL APPROVAL.

**REVISIONS:**

Rev	Comments	Drawn	Chk'd	Date
P1	Drawing created	aps	lrf/s	28/03/18
A	Proposed new A/C riser added	aps	lrf/s	13/04/18
B	New fire exit, riser 3 added	aps	lrf/s	17/04/18
C	New lift lobby created	aps	lrf/s	04/05/18
D	Disabled toilet amended.	aps	lrf/s	11/05/18
	Tenant & Landlord riser added			
E	New Ladies & Gents WC's added	aps	lrf/s	22/05/18
F	Balconies added	aps	lrf/s	23/05/18
G	Nett Area amended	aps	lrf/s	24/05/18

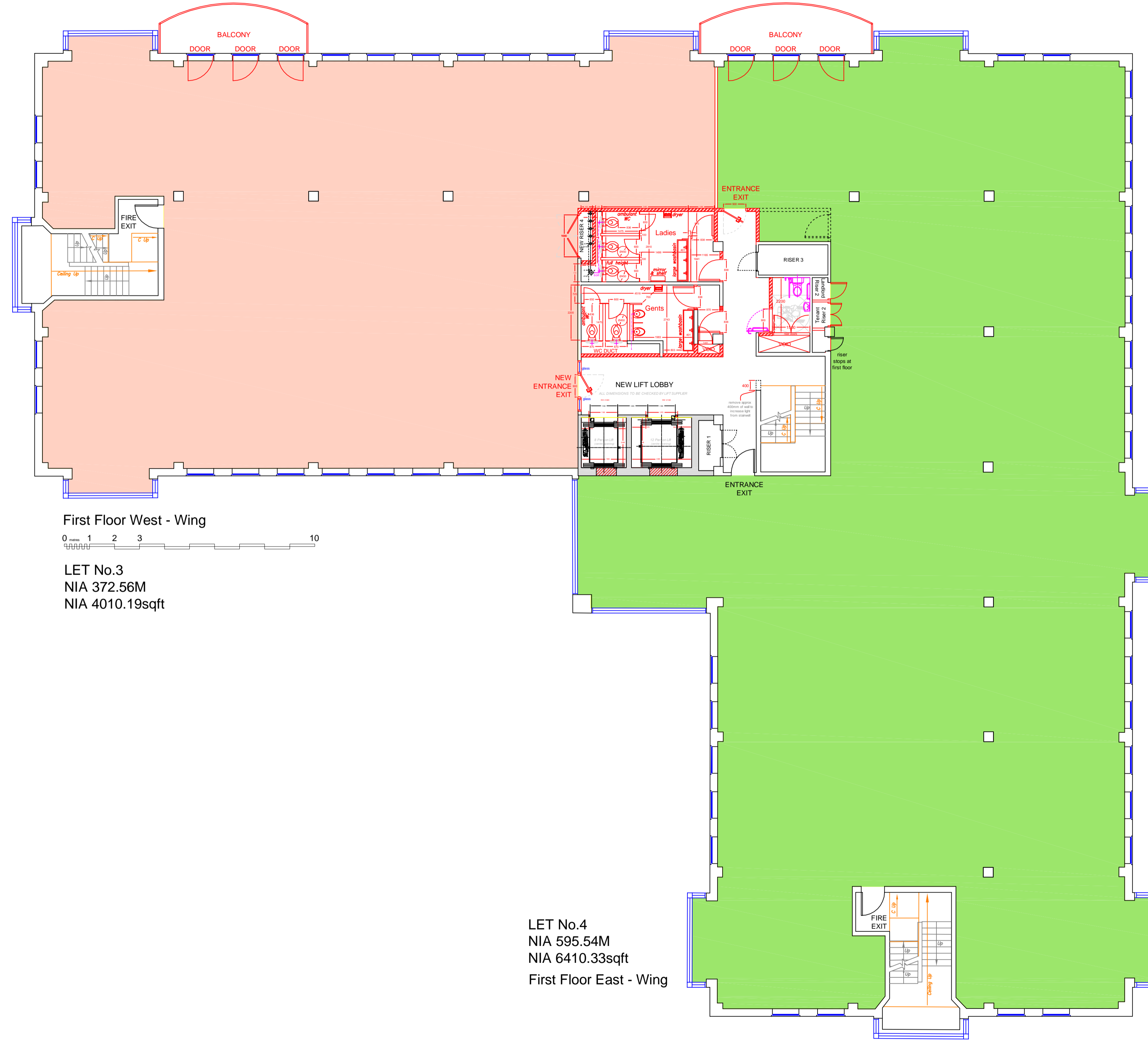

First Floor West - Wing  
 0 1 2 3 10  
 LET No.3  
 NIA 372.56M  
 NIA 4010.19sqft

LET No.4  
 NIA 595.54M  
 NIA 6410.33sqft  
 First Floor East - Wing

**CLIENT:**  
 London & Marlborough Group

**PROJECT:**  
 Waterfront House

**DRAWING TITLE:**  
 Proposed  
 Nett Internal Area

**LEVEL:**  
 First Floor

**ROK Consulting**

ROK Consulting  
 8 Castle Street  
 Farnham  
 Surrey GU9 7HR  
 Tel. 01428 714092

**DESIGN STATUS**  
 PRELIMINARY

DESIGNED BY	APS
DATE	12/12/2017
SCALE	1:100 @A1
CAD BY	APS
SIGN OFF	
DWG No:	0125 - 01 - NIA
Rev	G

01